

STAINLESS STEEL COMBI HINGES

DESCRIPTION	To hinge panels
MATERIAL	Hinge leaves: Stainless steel SS316 Hinge pin: Stainless steel
SURFACE	Polished

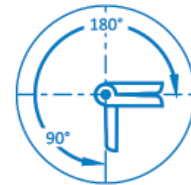

Non Lift Off

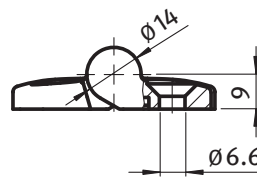
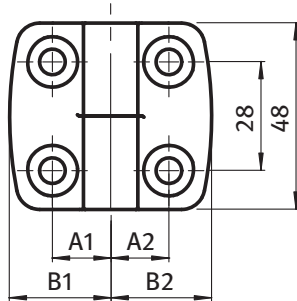

Lift Off

Asymmetric hinges available on request

Stainless Steel Combi Hinges	A1 [mm]	A2 [mm]	B1 [mm]	B2 [mm]	Left Hand	Right Hand	Non-Lift Off
	15.0	15.0	26.0	26.0	SSCH25L	SSCH25R	SSCH25F
	17.5	17.5	29.5	29.5	SSCH30L	SSCH30R	SSCH30F
	20.0	20.0	36.0	36.0	SSCH35L	SSCH35R	SSCH35F
	22.5	22.5	38.5	38.5	SSCH40L	SSCH40R	SSCH40F
	25.0	25.0	43.5	43.5	SSCH45L	SSCH45R	SSCH45F
	27.5	27.5	48.5	48.5	SSCH50L	SSCH50R	SSCH50F
	32.5	32.5	57.5	57.5	SSCH60L	SSCH60R	SSCH60F