

**HANDLE COMPRESSION LATCHES**

<b>DESCRIPTION</b>	For easy, secure, and compressive latching and locking of doors and flaps. Panel thickness must be 1 - 11 mm.
<b>MATERIAL</b>	Housing, handle, and trigger: Die-cast zinc Bolt: Mild steel
<b>SURFACE</b>	Housing, handle, and trigger: Black powder coated Bolt: Zinc plated

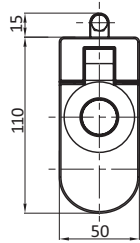

Non-locking

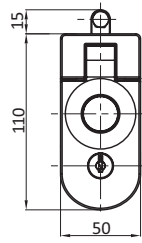

Key Locking

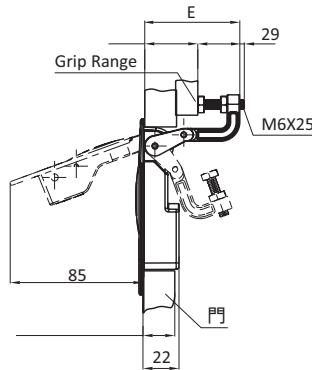

Max. panel Ts see table

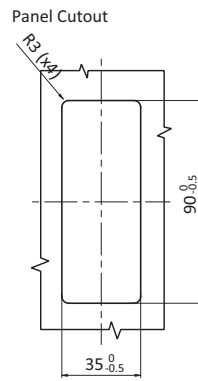
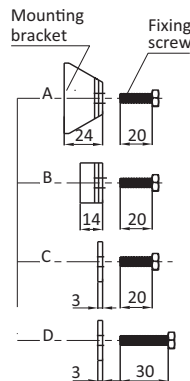

Mounting Bracke	Panel Thickness Min - Max (mm)	Grip Range Min - Max (mm)	E (mm)	Non Locking	FH751 Key Locking with Shutter	FH751 Key Locking	Phillips Drive
A	1 - 11	1 - 14	29	<b>HCL072</b>	<b>HCL01</b>	<b>HCL076</b>	<b>0HCL03</b>
B	11 - 21	1 - 14	29	<b>HCL04</b>	<b>HCL05</b>	<b>HCL06</b>	<b>HCL07</b>
A	1 - 11	14 - 29	44	<b>HCL073</b>	<b>HCL09</b>	<b>HCL077</b>	<b>HCL011</b>
B	11 - 21	14 - 29	44	<b>HCL012</b>	<b>HCL013</b>	<b>HCL014</b>	<b>HCL015</b>
C	21 - 31	14 - 29	44	<b>HCL016</b>	<b>HCL017</b>	<b>HCL018</b>	<b>HCL019</b>
A	1 - 11	29 - 45	60	<b>HCL074</b>	<b>HCL021</b>	<b>HCL088</b>	<b>HCL023</b>
B	11 - 21	29 - 45	60	<b>HCL024</b>	<b>HCL025</b>	<b>HCL026</b>	<b>HCL027</b>
C	21 - 31	29 - 45	60	<b>HCL028</b>	<b>HCL029</b>	<b>HCL030</b>	<b>HCL031</b>
D	31 - 41	29 - 45	60	<b>HCL032</b>	<b>HCL033</b>	<b>HCL034</b>	<b>HCL035</b>
A	1 - 11	45 - 57	72	<b>HCL075</b>	<b>HCL037</b>	<b>HCL089</b>	<b>HCL039</b>
B	11 - 21	45 - 57	72	<b>HCL040</b>	<b>HCL041</b>	<b>HCL042</b>	<b>HCL043</b>
C	21 - 31	45 - 57	72	<b>HCL044</b>	<b>HCL045</b>	<b>HCL046</b>	<b>HCL047</b>
D	31 - 41	45 - 57	72	<b>HCL048</b>	<b>HCL049</b>	<b>HCL050</b>	<b>HCL051</b>