

**LARGE COMPRESSION LATCHES**

DESCRIPTION	For easy, secure, and compressive latching and locking of doors and flaps.
MATERIAL	Housing and cylinder: Die-cast zinc Cam: mild steel
SURFACE	Housing and cylinder: Black powder coated Cam: zinc plated
SPECIALS	Right and left

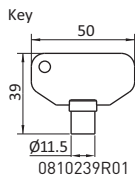
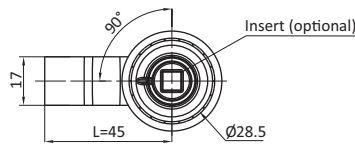
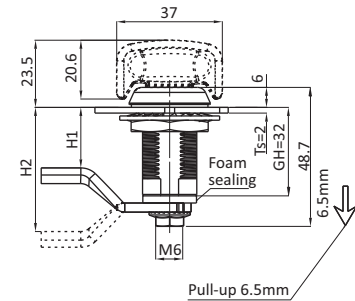

Optional components:

Pull-tab

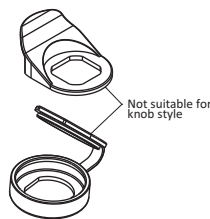

Water dust proof cover

Panel Cutout

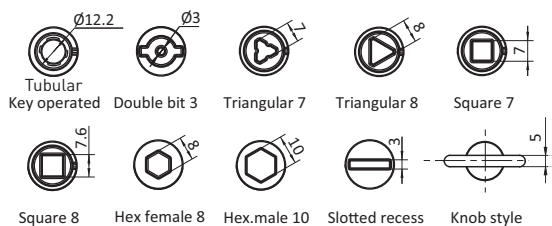
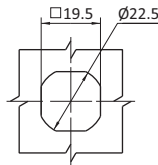

Large Compression Latches	Cylinder Style	Part #
	Tubular Key	LCL488
	Double Bit w. 4mm Pin	LCL489
	Triangle 7 mm	LCL490
	Triangle 8 mm	LCL491
	Square 7 mm	LCL492
	Square 8 mm	LCL493
	Slotted Recess	LCL494
	Female Hex 8 mm	LCL495
	Male Hex 10 mm	LCL496
	Knob Style	LCL497