

SCREW-ON HINGE

DESCRIPTION	To hinge panels
MATERIAL	Hinge: Die cast zinc Pin: SS
SURFACE	Black powder coated / Matte silver spray painted
SPECIALS	Non lift off Left and right

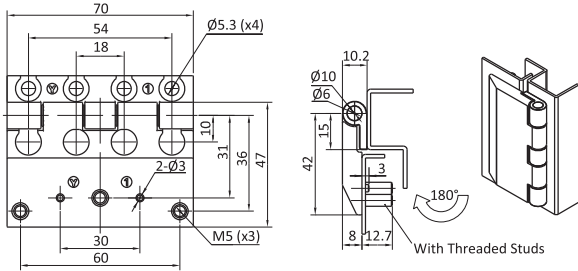

Screw-On Hinge

Black Powder Coated

MN Spray Painted (Matte silver)

with M5 threaded stud

SOH349
SOH350
STAMPED METAL HINGES

DESCRIPTION	To hinge panels
MATERIAL	316 SS
COLOR	Natural, Passivated
FASTENING	From the front, using M6 countersunk screws

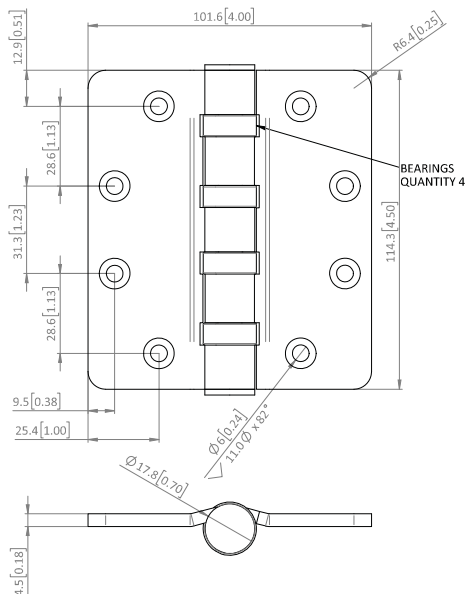

Part #

SOH262