

**FRICTION HINGES**

DESCRIPTION	To hinge panels
MATERIAL	Hinge leaves: Acetal Hinge pin: Polycarbonate
COLOR	Hinge leaves: Black and white
SPECIALS	Life: Within 20 Percent of stated torque after 25,000 cycles

Large Size

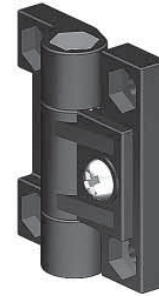
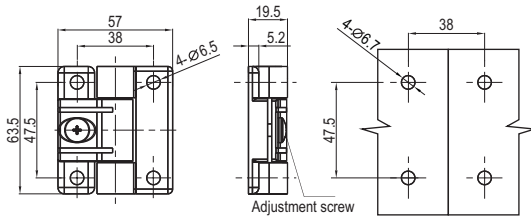

Small Size

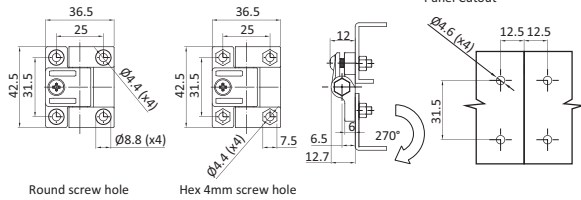

Round screw hole

Hex 4mm screw hole

Black

White

	Round screw hole	Hex 4mm screw hole	Round screw hole	Hex 4mm screw hole
Small version	<b>FHSRSB290</b>	<b>FHSHSB15</b>	<b>FHSRSW292</b>	<b>FHSHSW293</b>
Large version	<b>FHLRSB184</b>			

DESCRIPTION	To hinge panels
MATERIAL	Hinge leaves: Die cast Zinc
SURFACE	Black powder coated
SPECIALS	Life: Within 20 Percent of stated torque after 25,000 cycles

Panel cutout

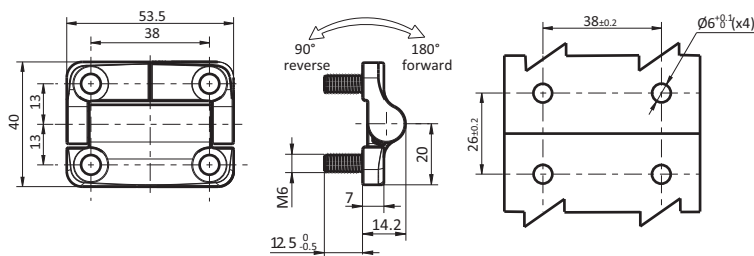

Metal Hinge with Constant Friction	Torque to open Nm(INLB)	Torque to close Nm(INLB)	Part #
Symmetric Torque	1.2 (10.6)	1.2 (10.6)	<b>FHST125</b>
	1.8 (16.0)	1.8 (16.0)	<b>FHST126</b>
	2.3 (20.4)	2.3 (20.4)	<b>FHST127</b>
	3.4 (30.1)	3.4 (30.1)	<b>FHST128</b>
	4.5 (39.8)	4.5 (39.8)	<b>FHST129</b>
Asymmetric Torque	2.3 (20.4)	1.4 (12.4)	<b>FHAT130</b>
	3.4 (30.1)	2.0 (17.7)	<b>FHAT131</b>
	4.5 (39.8)	2.7 (23.9)	<b>FHAT132</b>
	1.4 (12.4)	2.3 (20.4)	<b>FHAT133</b>
	2.0 (17.7)	3.4 (30.1)	<b>FHAT134</b>
	2.7 (23.9)	4.5 (39.8)	<b>FHAT135</b>