

03 SERIES 10 SERIES 11 SERIES

- Straight round shield caps (see figure 1)
- Straight roundflat shield caps (see figure 2)
- UL temperature rating: 105°C
- CSA temperature rating: 90°C
- UL voltage: 600V
- CSA voltage: 300V

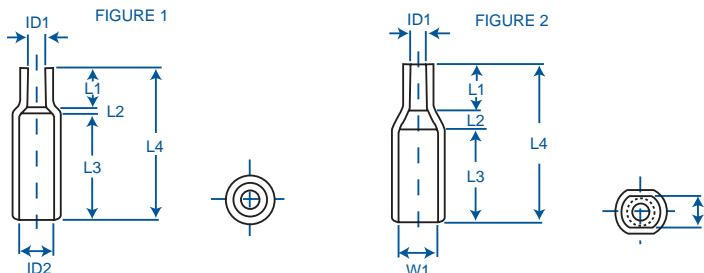

ITEM NO.	10-03-Series 10-10-Series 10-11-Series
COLOR:	Transparent Blue* <small>*Other colors available; inquiries welcome</small>
PACKAGING:	1000/bag
MATERIAL:	Soft PVC

MATERIAL	PRODUCT
UL YELLOW CARD FILE #: E58538(S)	E55167(S)
CSA #:	— LR52853 & LR52854

ITEM NO.	ID1		ID2		L1		L2		L3		L4		W1		W2		Figure No.	
	inches	(mm)	inches	(mm)	inches	(mm)	inches	(mm)	inches	(mm)	inches	(mm)	inches	(mm)	inches	(mm)		
10-03-314	.055	(1.4)	.091	(2.3)	.433	(11.0)	.079	(2.0)	.276	(7.0)	.787	(20.0)					1	
10-03-715	.059	(1.5)	.106	(2.7)	.079	(2.0)	.020	(.5)	.335	(8.5)	.433	(11.0)						
10-03-015			.118	(3.0)	.118	(3.0)			.433	(11.0)	.591	(15.0)						
10-03-020	.079	(2.0)	.118	(3.0)	.197	(5.0)	.039	(1.0)	.394	(10.0)	.551	(14.0)						
10-03-3314	.055	(1.4)					.433	(11.0)	.669	(17.0)								
10-03-320	.079	(2.0)	.130	(3.3)	.433	(1.0)	.079	(2.0)	.276	(7.0)	.787	(20.0)						
10-03-525	.098	(2.5)	.138	(3.5)	.118	(3.0)	.079	(2.0)	.315	(8.0)	.512	(13.0)						
10-03-420	.079	(2.0)	.173	(4.4)	.236	(6.0)	.118	(3.0)	.512	(13.0)	.866	(22.0)						
10-03-428	.110	(2.8)					.551	(14.0)	.827	(21.0)								
10-03-131	.122	(3.1)	.201	(5.1)	.158	(4.0)	.039	(1.0)	.394	(10.0)	.591	(15.0)						
10-03-228	.110	(2.8)	.205	(5.2)	.236	(6.0)			.551	(14.0)	.827	(21.0)						
10-03-530	.118	(3.0)	.217	(5.5)	.079	(2.0)			.472	(12.0)	.591	(15.0)						
10-03-6228	.110	(2.8)	.244	(6.2)	.276	(7.0)	.079	(2.0)	.591	(15.0)	.945	(24.0)						
10-03-045	.177	(4.5)	.276	(7.0)	.098	(2.5)	.039	(1.0)	.512	(13.0)	.650	(16.5)						
10-10-315	.059	(1.5)			.118	(3.0)	.039	(1.0)	.315	(8.0)	.472	(12.0)	.091	(2.3)	.059	(1.5)		2
10-10-418	.079	(2.0)			.197	(5.0)	.079	(2.0)	.394	(10.0)	.126	(3.2)	.095	(2.4)	.079	(2.0)		
10-10-215	.094	(2.4)					.315	(8.0)			.126	(3.2)	.095	(2.4)				
10-11-0201	.083	(2.1)			.118	(3.0)	.079	(2.0)	.394	(10.0)	.591	(15.0)	.158	(4.0)	.083	(2.1)		
10-11-020	.091	(2.3)							.161	(4.1)			.094	(2.4)				
10-11-125	.094	(2.4)			.197	(5.0)			.315	(8.0)			.169	(4.3)	.146	(3.7)		
10-11-332	.146	(3.7)							.323	(8.2)								
Tolerance ±					.039	(1.0)			.039	(1.0)								