

## 06 SERIES

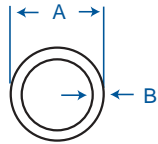

- Spiral wrap (forward cut)
- For General Use: Polyethylene (up to 215°F)  
Nylon (up to 200°F)
- Black (UV resistant)
- Additional colors/materials available (special order)

ITEM NO. (Polyethylene)		"A" Ref		"B" Ref		Maximum Bundle Range	
Natural	Black	inches	(mm)	inches	(mm)	inches	(mm)
08-06-125-PN	08-06-125-PBK	.125	(3.2)	.032	(.80)	.063-500	(1.6-12.7)
08-06-187-PN	08-06-187-PBK	.187	(4.8)	.030	(.76)	.187-1.50	(4.8-38.1)
08-06-250-PN	08-06-250-PBK	.250	(6.4)	.045	(1.1)	.187-2.00	(4.8-50.8)
08-06-375-PN	08-06-375-PBK	.375	(9.5)	.052	(1.3)	.312-3.00	(7.9-76.2)
08-06-500-PN	08-06-500-PBK	.500	(12.7)	.062	(1.6)	.375-4.00	(9.5-101.6)
08-06-625-PN	08-06-625-PBK	.625	(15.9)	.062	(1.6)	.500-4.50	(12.7-114.3)
08-06-750-PN	08-06-750-PBK	.750	(19.1)	.065	(1.7)	.750-5.00	(19.1-127.0)
08-06-1000-PN	08-06-1000-PBK	1.00	(25.4)	.080	(2.0)	1.00-7.00	(25.4-177.8)
Tolerance: ± .015							
(Nylon)							
08-06-125-NN	08-06-125-NBK	.125	(3.2)	.015	(.4)	.063-500	(1.6-12.7)
08-06-187-NN	08-06-187-NBK	.187	(4.8)	.020	(.5)	.187-1.50	(4.8-38.1)
08-06-250-NN	08-06-250-NBK	.250	(6.4)	.025	(.6)	.187-2.00	(4.8-50.8)
08-06-375-NN	08-06-375-NBK	.375	(9.5)	.035	(.9)	.312-3.00	(7.9-76.2)
08-06-500-NN	08-06-500-NBK	.500	(12.7)	.035	(.9)	.375-4.00	(9.5-101.6)
08-06-625-NN	08-06-625-NBK	.625	(15.9)	.032	(.8)	.500-4.50	(12.7-114.3)
08-06-750-NN	08-06-750-NBK	.750	(19.1)	.032	(.8)	.500-5.00	(12.7-127.0)
08-06-1000-NN	08-06-1000-NBK	1.00	(25.4)	.032	(.8)	1.000-7.000	(25.4-177.8)
Tolerance: ± .015							

	ITEM NO.	
	08-06-__-N Series	08-06-__-BK Series
<b>COLOR:</b>	Natural	Black
<b>PACKAGING:</b>	100 Ft/Roll	100 Ft/Roll
<b>MATERIAL:</b>	Polyethylene Nylon	Polyethylene Nylon

## 20 SERIES

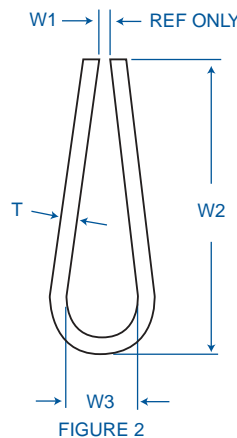
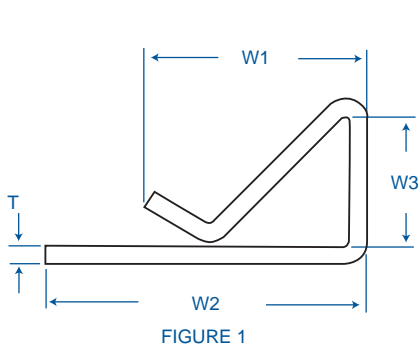

- Protects, smooths and binds edges and frames
- Attractive finished look to edges
- Material: UL94HB (E55470(M))

ITEM NO. 08-20-Series	
<b>COLOR:</b>	White
<b>PACKAGING:</b>	25 - 4 Ft bundles* *Custom lengths available; inquiries welcome.
<b>MATERIAL:</b>	High Impact Polystyrene

ITEM NO.	Length		W <sub>1</sub>		W <sub>2</sub>		W <sub>3</sub>		T		Figure No.
	inches	(mm)	inches	(mm)	inches	(mm)	inches	(mm)	inches	(mm)	
08-20-141	48.0	(1220.0)	.020	(.5)	.563	(14.3)	.141	(3.6)	.031	(.8)	2
08-20-250	48.0	(1220.0)	.433	(11.0)	.625	(15.9)	.250	(6.4)	.031	(.8)	1

