

11 SERIES
12 SERIES

- Screw mount cable tie holders
- Material: UL94V-2 (E41938)

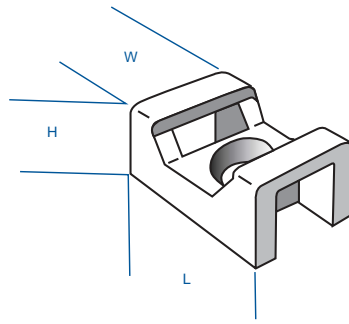

FIGURE 1

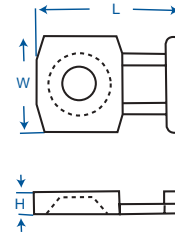

FIGURE 2

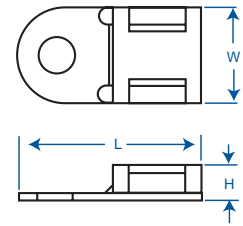

FIGURE 3

	ITEM NO. 02-11-Series 02-12-Series
COLOR:	Natural
PACKAGING:	500/bag
MATERIAL:	Nylon 66

ITEM NO.	"W"		"L"		"H"		Maximum Tie Width inches (mm)	Screw Size	Fig. No.
	inches	(mm)	inches	(mm)	inches	(mm)			
02-11-10	.40	(10.1)	.615	(15.6)	.27	(6.9)	.19 (4.8) Wide	#6 (M3.5) #8 (M4)	1
02-11-20	.64	(15.9)	.905	(22.9)	.37	(9.4)	.30 (7.6) Wide	#10 (M5)	1
02-12-10	.50	(12.7)	.75	(19.1)	.12	(3.4)	.22 (5.6) Wide	#8 (M4)	2
02-12-20	.374	(9.5)	.748	(19.0)	.196	(5.0)	.196 (5.0)	#6 (M3.5)	3
Tolerances:	± .010								

51 SERIES
52 SERIES

- Installs easily to chassis
- Arrowhead locks securely into hole

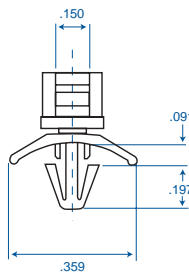

FIGURE 1

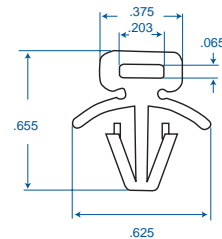
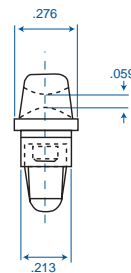

FIGURE 2

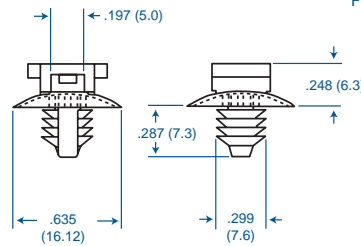

FIGURE 3

	ITEM NO.	
	02-51 Series	02-52 Series
COLOR:	Natural	Black
PACKAGING:	500/bag	500/bag
MATERIAL:	Nylon 66	Nylon 66

ITEM NO.		Mounting Hole Diam. inches (mm)	Chassis Thickness inches (mm)	Cable Tie Used lb (Kg)	Fig. No.
UL94V-2	UL94V-0				
02-51-30	02-51-30X	.189 (4.8)	.020-.079 (.5-2.0)	18-30 (8.2-13.6)	1
02-51-40	—	.250 (6.4)	.047-.109 (1.19-2.77)	18-50 (8.2-22.7)	2
02-52-50	—	.250-.276 (6.4-7.0)	.031-.276 (.8-7.0)	18-50 (8.2-22.7)	3